



Search
Results



Categories
Category Pages



Single Item
Display Page



Exploded Diagrams
Service & Support



Unshipped
Orders



Invoice History
& RMA



Purchase History
Managing Quotes



Pricing Display
Order Reference



Edit Restricted
Users

*Horizon*TM
Spa & Pool Parts, Inc.

WELCOME TO OUR WEBSITE

COMPLETE "HOW TO" GUIDE

www.horizonparts.com

WELCOME TO OUR WEBSITE

COMPLETE “HOW TO” GUIDE

TABLE OF CONTENTS

Search & Results.....	1
Categories & Category Pages.....	2
Single Item Display Page.....	3
Exploded Diagrams.....	4
Service & Support.....	5
Unshipped Orders.....	6
Invoice History / RMA.....	7
Purchase History / Managing Quotes.....	8
Upload/Edit Logo & Pricing Display / Order Reference.....	9
Edit Restricted Users.....	10

WE'VE UPGRADED OUR SEARCH ENGINE, MAKING IT EASIER TO FIND THE RIGHT PART, THE FIRST TIME!

SEARCH

1 Element 5.5Kw

2 Wholesale Parts

Home Wholesale Parts Service & Support My Account Administrator: Alison Root Log Out View Cart

Product Description or Part #

Providing Parts & Knowledge To Serve The Industry

Shop All Parts >> Visit the Full Parts Index to start shopping

Current Specials >> Find sale & discount items here

Exploded Diagrams >> View and interact with our diagrams

Industry Events >> Click here for industry event information

2 Shop All Parts >> Visit the Full Parts Index to start shopping

3 Exploded Diagrams >> View and interact with our diagrams

RESULTS

4 Categories: Heater Elements

Search Results For: Element 5.5Kw

Categories: Heater Elements

Sort By: Best Match Items/Page: 25 In Stock Only

Product Description	Status	Wholesale Price
Element, Coates 6LS, 5.5KW, 240v, Titanium Horizon # 47-225-1722 Mant. # 20005155	In Stock	\$68.99
Flange Element, 3" x 3", 5.5KW, Raypak, 230v, with Gasket Horizon # 47-555-2065 Mant. # 001601F	In Stock	\$78.76
Flange Element, 3" x 3", 5.5KW, Raypak, 230v, with Gasket Horizon # 47-555-2065 Mant. # 001601F	In Stock	\$156.99

4 Sort By: Best Match In Stock Only

1

Product Description or Part #

Providing Parts & Knowledge To Serve The Industry

Industry Events >> Click here for industry event information

2

Full Index

A - F	G - P	Q - Z
Accessories	Hardware	Pool and Deck Safety
Audio Equipment	Hardware	Pool and Deck Safety
Cover Reels	Fasteners	Pool and Deck Safety
Spa Cover Lift Assembly	Nuts	Pool and Deck Safety
Spa Pillows	Washers	Pool and Deck Safety
Swim Equipment	Heaters	Pool and Deck Safety
Thermometers	Bath Heaters	Pool and Deck Safety
Toys and Games	Flow Thru Heaters	Pool and Deck Safety
Air Blowers & Injectors	Heater Hardware	Pool and Deck Safety
Air Blowers	Heater Elements	Pool and Deck Safety
Commercial	Heater Sensors & Switches	Pool and Deck Safety
Residential	Freeze Sensors	Pool and Deck Safety
Air Blower Parts	W/L Units	Pool and Deck Safety
Air Injectors	Pressure Switches	Pool and Deck Safety
Air Buttons	Thermostats	Pool and Deck Safety
Air Buttons	Vacuum Switches	Pool and Deck Safety
Air Button Parts	Low Flow Heaters	Pool and Deck Safety
Air Controls	Outdoor Heaters	Pool and Deck Safety
	Heater Components	Pool and Deck Safety
	Heat Pump Parts	Pool and Deck Safety
	Screw Plug Heaters	Pool and Deck Safety

3

Waterway Executive 48 Frame Parts & Wel...

Product Description: Waterway Executive 48 Frame Parts & Wel...
 Product Categories: Waterway Executive 48 Frame Parts & Wel...
 Part # 47-225-1722
 Mant. # 20005155

4

Search Results For: Element 5.5Kw

Categories: Heater Elements

Sort By: Best Match Items/Page: 25 In Stock Only

Product Description	Status
Coil Element, Castiner, 5.5KW, 6", Titanium Horizon # 47-555-2062 Mant. # 001601F	In Stock
Element, Coates 6LS, 5.5KW, 240v, Titanium Horizon # 47-225-1722 Mant. # 20005155	In Stock
Flange Element, 3" x 3", 5.5KW, Raypak, 230v, with Gasket Horizon # 47-555-2065 Mant. # 001601F	In Stock
Flange Element, 5" x 5", 1.375/5.5KW, Uni-Brent, 115v/230v, Tit Horizon # 47-555-2037 Mant. # 001601F	In Stock
Flow Thru Element, 5.5KW, 230v, 10", Middle Terminal Horizon # 47-555-2315 Mant. # 0245038	In Stock
Flow Thru Element, 5.5KW, Generic, 10", 115v/230v, Grey	In Stock

SEARCH BAR

- Search with Words
- Horizon Item Numbers
- Manufacturers' Numbers
- Other Vendors' Numbers

PARTS INDEX

- Navigate to Categories Either Using the "Wholesale Parts" Link on the Menu Bar or by the Left Pane "Parts Categories."

EXPLODED DIAGRAMS

- Parts Lookup by Category, Manufacturer and Model in Interactive Diagrams.

SEARCH RESULTS

- Sort by Defaults to "Best Match"
- Use "In Stock Only" to Filter Available Parts
- Click on "Category Link" to See All Heater Elements

CATEGORIES & CATEGORY PAGES



- 1 **Shop All Parts** »
Visit the Full Parts Index to start shopping
- Current Specials** »
Find sale & discount items here
- Exploded Diagrams** »
View and interact with our diagrams
- Industry Events** »
Click here for industry event information

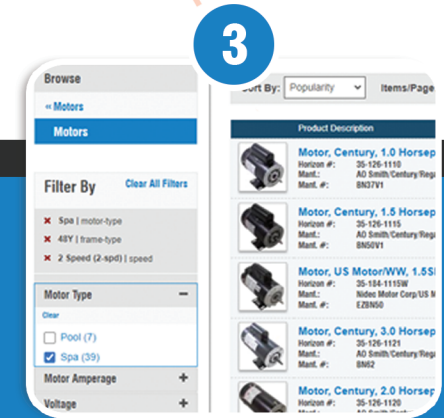
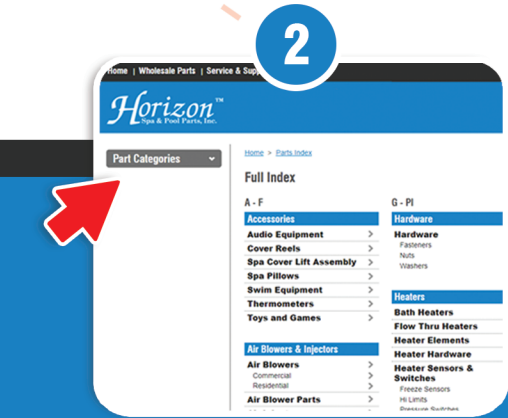
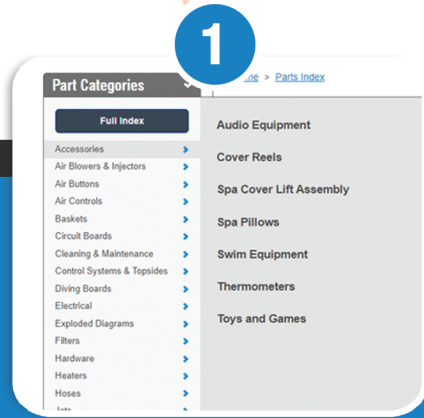
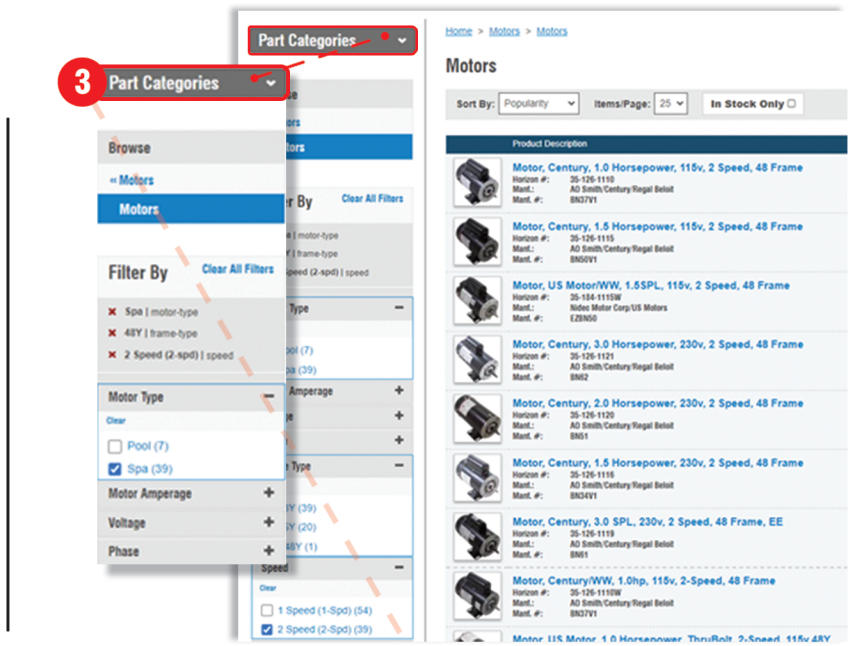
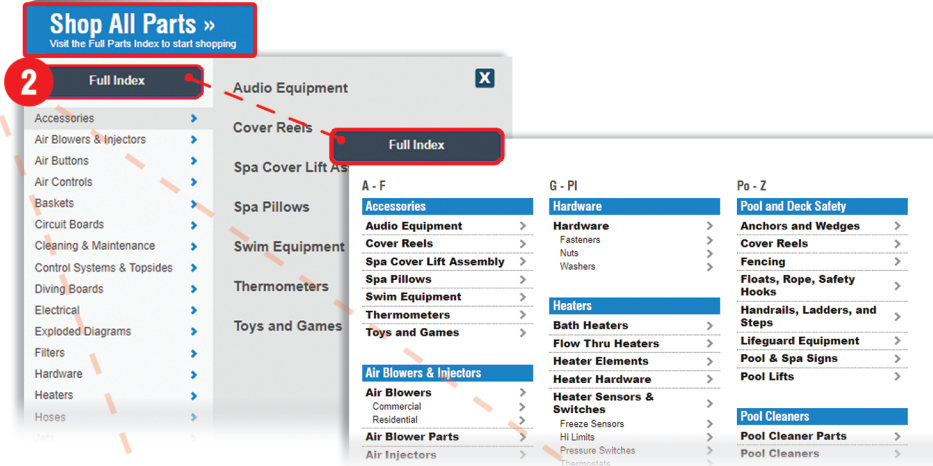

CATEGORIES

- Navigate to Categories Using “Shop All Parts” Link, Above the Homepage Banners

FULL PARTS INDEX

- To See Our Entire Parts Index, Click “Full Index”

www.horizonparts.com

CATEGORY PAGES

- Use **Attribute Filters** in the Left Pane
- “Sort By” Defaults to the **Most Popular** Items
- Use “In Stock Only” to Filter **Available Parts**

SINGLE ITEM DISPLAY PAGE

DESCRIPTION

Motor, Century, 1.0 Horsepower, 115v, 2 Speed, 48 Frame

Full Description | Exploded Diagram | Available Styles | Documentation | Specifications | Commonly Replaced



HORIZON ITEM

Horizon # 35-126-1110

Manufacturer: AO Smith/Century/Regal Beloit
 Manufacturer #: BN37V1

Replaces: 1-20-0002, 15698, 15700, 177782, 222449, 3420410, 3J20410, 786674014405, 817778200, AGL10FL2S

MANUFACTURER

MANUFACTURER

OTHER #'S

For shipment today from our Tucson Warehouse, order within the next 7 minutes!
 For shipment on the next business day from our Memphis Warehouse, order within the next day.
 Also, be sure to check out our new return policy. [Learn More](#)

In Stock

Wholesale Price:

\$228.19

Quantity:

QUANTITY BOX

+ ADD TO CART

ADD TO CART

Want this part shipped today?

[Register now](#) to become a Horizon dealer. [Learn More](#)

Multiple Views:



MULTIPLE VIEWS

Detailed Product Info

- 1
- 2
- 3
- 4
- 5

Full Description	Exploded Diagram	Available Styles	Documentation	Specifications	Commonly Replaced Items
<p>CAT: BN37 VOLTS: 115 MODEL: 177782AMPS: 10.8/2.8 TYPE: CSM MAX AMPS: FR: R 48 Y SF AMPS: HP: TIME: CONT SF: ENCL: ODP THERMALLY PROTECTED PH: 1 FORM: HZ: 60 CODE: A RPM: 3450/1725INSUL CLASS: B ROT: CCWPE AMB: 40</p> <ul style="list-style-type: none"> • 12 & 3 O'clock Conduit Entries • 40°C Ambient • Class B Insulation • Rotation: CCW Pump End • Through Bolt Mount • 48/56 Base Mounting • 3-1/2" Shaft Height • Four Thru Bolts on a 5.146 Bolt Circle 					

RECOMMENDED ITEMS

Recommended Items

99-361-1160
 Tool, Pool Tool, Impeller Wedge, 48 Frame
\$9.13
 Add

99-242-1100
 Tool, Clamp-On Multimeter, Tenma, with Sensor and Leads
\$46.78
 Add

60-555-1780
 Disconnect, 90° Female, 22-18AWG, 250 Tab, Bare, qty 25
\$11.82
 Add

60-355-1030
 Cord, H-Q, P2, 2-Spd, Molded/Lit, 48", 115v/230v, 15A, Brown
\$15.14
 Add

99-366-1075
 Tool, Seal Setting
\$52.61
 Add

59-270-1010
 Motor Base, Waterway, Self Aligning, 48 Frame, Rubber
\$3.72
 Add

60-337-1724
 HC Cord, Gecko, 2 Speed Pump, 15A, 115v, 96
 Add

[Back To Top](#)

1

Full Description | Exploded | Available Styles | Doc

CAT: BN37 VOLTS: 115
 MODEL: 177782AMPS: 10.8/2.8
 TYPE: CSM MAX AMPS:
 FR: R 48 Y SF AMPS:
 HP: TIME: CONT
 SF: ENCL: ODP THERMALLY PROTECTED
 PH: 1 FORM:
 HZ: 60 CODE: A
 RPM: 3450/1725INSUL CLASS: B
 ROT: CCWPE AMB: 40

- 12 & 3 O'clock Conduit Entries

FULL DESCRIPTION

- Helpful Information

2

Full Description | Exploded | Available Styles | Documentation

Horizon #	Description
34-102-W017	Pentair Sta-Rite JW/JW Above-Ground/JWPA Series Pump
34-102-W030	StaRite Dura-Jet DJ Series Pumps
34-102-W033	StaRite Dura-Jet JT Series Pumps
34-105-W003	Jouuzzi J, JCM, K, KM Series Pumps
34-105-W005	Jouuzzi L.L.C. LCUN2, LT, LK, LTC, LCU, LCM, ULC, ULU
34-105-W007	Jouuzzi L3 & L25 Model Pumps
34-105-W009	Jouuzzi LH & LTH Model Pumps
*4-105-W011	Jouuzzi LPH, LPC, LTPH Model Pumps

EXPLODED DIAGRAMS

- List of Manufacturers' Models Using This Item.
- Hyperlinks to Each Exploded Diagram

3

am | Available Styles | Documentation | Specifications | Comm

Description

A.O Smith BN37 Motor Tech Sheet
 A.O.Smith-Horizon Warranty Information

DOCUMENTATION

- Documents In Our Tech Library For This Item
- Hyperlinks to Document

4

Available Styles | Documentation | Applications | Commonly Replaced Items

Search Using These Specs

Motor Type	Spa
Motor Amperage	10.8A/2.8A
Voltage	115v
Phase	1 Phase (1ph)
Frame Type	48Y
Speed	2 Speed (2-Spd)
Horsepower	1.0hp

SPECIFICATIONS

- All of the Attributes for This Item, with a Button "Search Using These Specs" Which Will Bring You To The Category Page with All Attribute Filters Selected

5

Styles | Documentation | Applications | Commonly Replaced Items

35-126-2086 Toggle Switch, Century Regal Beloit, 2-Spd \$53.36 <input type="text"/> Add	35-125-21 Terminal I Century \$14.12 <input type="text"/> Add
35-125-2160 Terminal Board, Century, Single Arm	

COMMONLY REPLACED ITEMS

- Common Wear Parts for This Specific Item

EXPLODED DIAGRAMS

Part Categories

Home > Exploded Diagrams > Exploded Diagrams > Pumps > 34-270-W013

Waterway Executive 48 Frame Parts & Wetends

Product Description · Parts · Executive Series Wet Ends, 2" Suction and 2" Discharge 48 Frame · Executive Series Wet Ends, 2-1/2" Suction and 2" Discharge 48 Frame · 1-Speed Motors · 2-Speed Motors · Pump and Motor Complete, Executive 48Fr 2" Suction, Less Trap (OEM) · Pump and Motor Complete, Executive 48Fr 2" Suction, Less Trap w/US or Century AO Smith Motor · Pump and Motor Complete, Executive 48Fr 2-1/2" Suction, Less Trap (OEM) · Pump and Motor Complete, Executive 48Fr 2-1/2" Suction, Less Trap w/US or Century AO Smith Motor

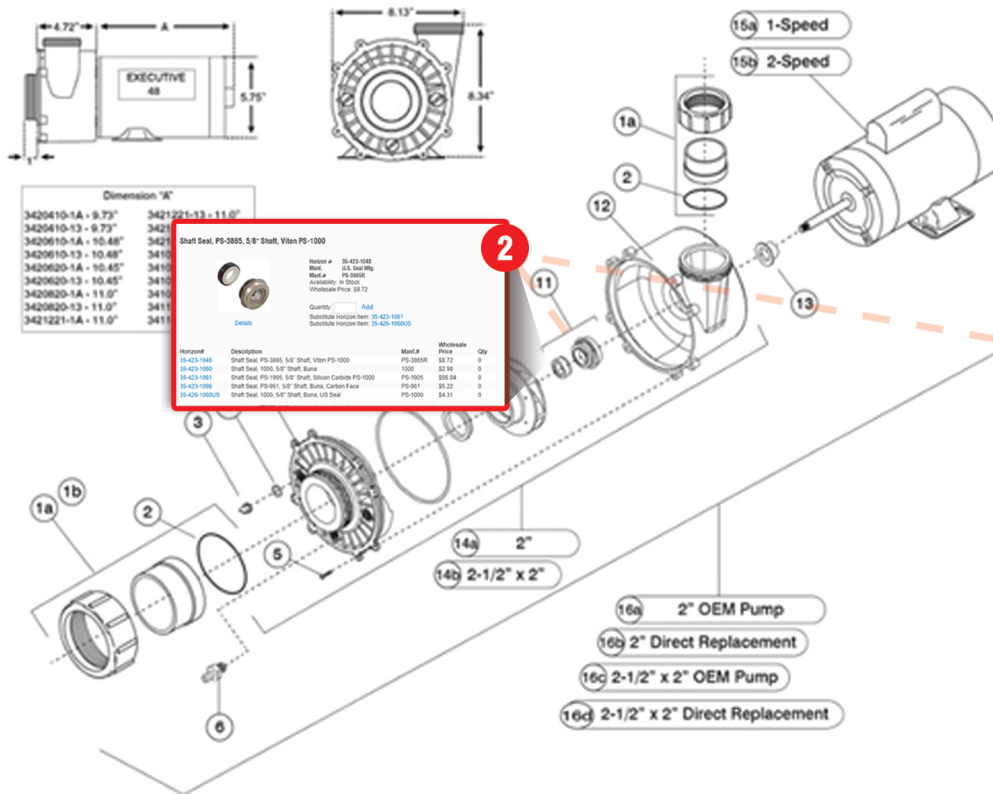

Dimension 'A'

3420410-1A - 9.73"	3421221-13 - 11.0"
3420410-13 - 9.73"	3421
3420610-1A - 10.48"	3421
3420610-13 - 10.48"	3419
3420620-1A - 10.45"	3419
3420620-13 - 10.45"	3419
3420820-1A - 11.0"	3419
3420820-13 - 11.0"	3419
3421221-1A - 11.0"	3419

2

Shaft Seal, PS-3865, 5/8" Shaft, Viton PS-1000

Horizon # 35-423-1048
 Man. U.S. Seal Mfg.
 Part # PS-3865R
 Availability: In Stock
 Wholesale Price: \$8.72

Quantity Add
 Substitute Horizon Item: 35-423-1061
 Substitute Horizon Item: 35-426-1060US

Horizon #	Description	Man.#	Wholesale Price	Qty
35-423-1048	Shaft Seal, PS-3865, 5/8" Shaft, Viton PS-1000	PS-3865R	\$1.72	0
35-423-1060	Shaft Seal, 1000, 5/8" Shaft, Buna	1000	\$1.90	0
35-423-1061	Shaft Seal, PS-1905, 5/8" Shaft, Silicon Carbide PS-1000	PS-1905	\$5.84	0
35-423-1096	Shaft Seal, PS-961, 5/8" Shaft, Buna, Carbon Face	PS-961	\$5.22	0
35-426-1060US	Shaft Seal, 1000, 5/8" Shaft, Buna, US Seal	PS-1000	\$4.31	0

1

Waterway Executive 48 Frame Parts & Wetends

DESCRIPTION

2

Shaft Seal, PS-3865, 5/8" Shaft, Viton PS-1000

Horizon # 35-423-1048
 Man. U.S. Seal Mfg.
 Part # PS-3865R
 Availability: In Stock
 Wholesale Price: \$8.72

Quantity Add
 Substitute Horizon Item: 35-423-1061
 Substitute Horizon Item: 35-426-1060US

Horizon #	Description	M
35-423-1048	Shaft Seal, PS-3865, 5/8" Shaft, Viton PS-1000	P
35-423-1060	Shaft Seal, 1000, 5/8" Shaft, Buna	1C
35-423-1061	Shaft Seal, PS-1905, 5/8" Shaft, Silicon Carbide PS-1000	P
35-423-1096	Shaft Seal, PS-961, 5/8" Shaft, Buna, Carbon Face	P
35-426-1060US	Shaft Seal, 1000, 5/8" Shaft, Buna, US Seal	P

CLICKABLE PART KEY NUMBERS

3

Parts

Key	Horizon #	Description
1a	89-270-1105	Pump Union, 2" Female Buttress Thread x 2" Slip
	89-270-1100	Pump Union, 2-1/2" Female Buttress Thread, 2"
	90-423-5232	O-Ring, 2-3/4" ID, 1/8" Cross Section, Generic
	35-270-1480	Drain Plug, Waterway
4	35-270-1705	O-Ring, Waterway, Drain Plug/Valve Stem
4	90-423-7111	O-Ring, 7/16" ID, 3/32" Cross Section, Generic
4	90-423-7112	O-Ring, 1/2" ID, 3/32" Cross Section, Generic

PARTS LIST

Parts

Key	Horizon #	Description	Man. #	Wholesale Price:	Qty
1a	89-270-1105	Pump Union, 2" Female Buttress Thread x 2" Slip	0602-20	\$4.22	<input type="text"/>
1b	89-270-1100	Pump Union, 2-1/2" Female Buttress Thread, 2" Slip	400-5900	\$8.83	<input type="text"/>
2	90-423-5232	O-Ring, 2-3/4" ID, 1/8" Cross Section, Generic		\$0.88	<input type="text"/>
3	35-270-1480	Drain Plug, Waterway	715-1201	\$1.68	<input type="text"/>
4	35-270-1705	O-Ring, Waterway, Drain Plug/Valve Stem	805-0112		<input type="text"/>
4	90-423-7111	O-Ring, 7/16" ID, 3/32" Cross Section, Generic	AS-148H	\$0.89	<input type="text"/>
4	90-423-7112	O-Ring, 1/2" ID, 3/32" Cross Section, Generic		\$0.88	<input type="text"/>

SERVICE & SUPPORT

Home | Wholesale Parts | Service & Support | My Account

Welcome: TEST001 | Log Out | View Cart

Product Description or Part #

Providing Parts & Knowledge To Serve The Industry

Part Categories

[Home](#) > [Service & Support](#)

Service & Support

Hot Spring Parts

[Go to our email request form](#) >

Registration

[New Dealer](#) >

[Existing Dealer](#) >

[Credit Application](#) >

Tech

[Documentation Library](#) >

[Match A Part](#) >

[Energy Efficiency Guide](#) >

Match A Part

Often we run into situations where we wished we could just show someone what we are talking about and then they would understand! Horizon can't be at your jobsite or at your store, but we can make it easy for you to send us a picture of that part you are trying to replace or that piece of equipment you are working on. Sending us pictures via horizonparts.com is as simple as filling out the form below and uploading your picture files where indicated. Be sure to include pictures from multiple angles and include measurement references such as a penny to give scale to the pictures if needed.

If you have a camera phone in the field and time is of the essence, the best way to send us a picture is to call our techs first so that we may prioritize your picture and get you the answer you need right away. We will give you the direct email to the tech you are speaking with. Otherwise, if you are not in the field or if time is not as much of an issue, simply use the form below and we will attend to your concern as soon as possible.

Use this form or if you'd prefer, you can email us at our email address with using your own email program. If you choose to mail in the part for matchup, please use this address:

Horizon Spa & Pool Parts, Inc.
Attn: Parts Match Service
3120 E. Medina Road
Tucson, AZ 85708

Your Information

Name:

Company:

Attention:

Address:

City:

State:

Zip:

Country:

Fax Number:

Company Phone:

Your Email Address:

Subject:

Reason for Submission: Repair Help Parts Match

Description of Submission:

File To Attach

First click "Browse" to locate the image file, then click attach to add file to submission list.

Chosen Attachments:

* = required fields

[Home](#) > [Document Finder](#)

Advanced Document Finder

Enter your search criteria below to search for a document.

Category:

Sub Category:

Sub Sub Category:

Document Type:

2

CAN'T FIND A PART?
OUR EXPERT
TECHNICIANS
CAN HELP!

[Home](#) > [Document Fi](#)

Advanced Document Finder

Enter your search criteria below to search for a doc

Category:

Sub Category:

Sub Sub Category:

Document Type:

1

TECHNICAL DOCUMENTATION LIBRARY

[Match A Part](#)

Often we run into situations where we wished we could just show someone what we are talking about and then they would understand! Horizon can't be at your jobsite or at your store, but we can make it easy for you to send us a picture of that part you are trying to replace or that piece of equipment you are working on. Sending us pictures via horizonparts.com is as simple as filling out the form below and uploading your picture files where indicated. Be sure to include pictures from multiple angles and include measurement as a penny to give scale to the pictures if needed.

If you have a camera phone in the field and time is of the essence, the best way to send us a picture is to call our techs first so that we may prioritize your picture and get you the answer you need right away. We will give you the direct email to the tech you are speaking with. Otherwise, if you are not in the field or if time is not as much of an issue, simply use the form below and we will attend to your concern as soon as possible.

Use this form or if you'd prefer, you can email us at our email address with using your own email program. If you choose to mail in the part for matchup, please use this address:

Horizon Spa & Pool Parts, Inc.
Attn: Parts Match Service
3120 E. Medina Road
Tucson, AZ 85708

Your Information

Name:

Company:

Attention:

Address:

2

MATCH A PART

MY ACCOUNT: UNSHIPPED ORDERS

SEE ORDERS THAT ARE WAITING TO SHIP

Home | Wholesale Parts | Service & Support | My Account | Log Out | View Cart

Product Description or Part # GO

Providing Parts & Knowledge To Serve The Industry

Part Categories

Home > My Account

My Account:

Horizon Customer - Fulfillment Center

Optimus Customer #: 666666

Status

Current Balance: \$1,144,360.22
YTD Purchases: \$7,770,744.91
Last Purchase Date: 7/11/2022

Account

Fulfillment Center
2000 E Indian School Road
Phoenix, AZ 85016
(602)944-2800

Account Directory:

- Unshipped Orders >
- Invoice History & RMA >
- Product Purchase History >
- Edit Billing & Email Addresses >
- Change Password >
- Maintain Ship-To Addresses >
- Manage Quotes >
- Upload/Edit Logo >
- Pricing Display & Order Reference >
- Session Pricing Display >
- Edit Restricted Users >
- Manage Quality Level Pop-up >

Home > My Account > Open Orders

Open Orders

1 Order #:

2 Purchase Order #:

3 Order date range: to

Show All

Get Orders Return To Account

Details	Order #	PO #	Order Date	Amount
View	3843527	MA05546400	7/12/2022	\$31.04
View	3843526	MA05546417	7/12/2022	\$33.81
View	3843525	MA05546433	7/12/2022	\$47.90
View	3843523	MA05546337	7/12/2022	\$26.31
View	3843522	MA05546303	7/12/2022	\$78.04
View	3843514	MA05546188	7/12/2022	\$137.59

1

Open Orders

Order #: 3820819

2

HORIZON ORDER #

Purchase Order #:

3

PURCHASE ORDER #

Order date range:

ORDER DATE RANGE

4

Details Order #
View 3820819

ORDER DETAILS

PURCHASE HISTORY

ITEMS PURCHASED ON YOUR ACCOUNT

Home > My Account > Purchase History

Product Purchase History

Description

- 1-1/2" 3 Port Perma-Sealvalve "Unionized"
- Hayward Peristaltic Chemical Feed Pump
- Flex Tube Assy, Hayward Perflex EC30/EC40/EC40AC/EC65(5 pak)
- Grid Assembly, Pentair PacFab FNS Plus, 48 sqft
- Basket Hayward Sp1600M
- Pressure Gauge, Hayward, 1/4"mpt, 0-60psi, Bottom Mount, w/Dial
- Plastic Pool/Spa Light Junction Box Mounting Bracket
- Diffuser, Pentair, Sta-Rite Anthony, 1 - 2.5hp
- Widemouth Screw Set
- Cartridge Element C100S

Description	Qty	Last Order Price	Last Order Date	Web Price
1-1/2" 3 Port Perma-Sealvalve "Unionized"	1	\$34.77	06/24/2022	\$34.77
Hayward Peristaltic Chemical Feed Pump	1	\$168.53	06/24/2022	\$168.53
Flex Tube Assy, Hayward Perflex EC30/EC40/EC40AC/EC65(5 pak)	16	\$18.40	06/24/2022	\$18.40
Grid Assembly, Pentair PacFab FNS Plus, 48 sqft	6	\$243.88	06/24/2022	\$243.88
Basket Hayward Sp1600M	1	\$7.35	06/24/2022	\$7.35
Pressure Gauge, Hayward, 1/4"mpt, 0-60psi, Bottom Mount, w/Dial	10	\$13.91	06/24/2022	\$13.91
Plastic Pool/Spa Light Junction Box Mounting Bracket	10	\$5.49	06/24/2022	\$5.49
Diffuser, Pentair, Sta-Rite Anthony, 1 - 2.5hp	1	\$17.15	06/24/2022	\$17.15
Widemouth Screw Set	27A	\$14.70	06/24/2022	\$14.70
Cartridge Element C100S	1	\$73.53	06/24/2022	\$73.53

Home > My Account > Purchase History

Product Purchase History

Description

- 1-1/2" 3 Port Perma-Sealvalve "Unionized"
- Hayward Peristaltic Chemical Feed Pump
- Flex Tube Assy, Hayward Perflex EC30/EC40/EC40AC/EC65(5 pak)
- Grid Assembly, Pentair PacFab FNS Plus, 48 sqft
- Basket Hayward Sp1600M
- Pressure Gauge, Hayward, 1/4"mpt, 0-60psi, Bottom Mount, w/Dial
- Plastic Pool/Spa Light Junction Box Mounting Bracket

ITEMS PURCHASED ON YOUR ACCOUNT

Qty	Last Order Price	Last Order Date	Web Price
1	\$34.77	06/24/2022	\$34.77
1	\$168.53	06/24/2022	\$168.53
16	\$18.40	06/24/2022	\$18.40
6	\$243.88	06/24/2022	\$243.88
1	\$7.35	06/24/2022	\$7.35
10	\$13.91	06/24/2022	\$13.91
10	\$5.49	06/24/2022	\$5.49
1	\$17.15	06/24/2022	\$17.15
27A	\$14.70	06/24/2022	\$14.70
1	\$73.53	06/24/2022	\$73.53

LAST DATE ITEM WAS PURCHASED

MANAGE QUOTES

USE TO BUILD QUOTES FROM ITEMS IN THE CART.

This can be used to quote a job to a customer or keep handy lists of parts to complete repeatable jobs like rebuilding a specific pump.

Home > My Account > Edit Quotes

Description	Quote ID	Created
WW Exec 4 HP Rebuild and Whole Pump	4153	6/24/2022

Your shopping cart

Home > My Account > Edit Quotes

Details of this saved order

Description	Item	Qty	Availability	Order	Price	Extended
Shaft Seal, PS-3885, 5/8" Shaft, Viton PS-1000	35-423-1048	1	1 available Immediately	1	\$8.72	\$8.72
Impeller, Waterway Executive, 4.0 HP, New Version (Blue)	35-270-1811	1	1 available Immediately	1	\$22.30	\$22.30
O-Ring, 1/2" ID, 1/2" O.D., Cross Section, Generic	90-423-7112	1	1 available Immediately	1	\$0.88	\$0.88
O-Ring, 1/2" ID, 1/2" O.D., Cross Section, Generic	270-3578	1	1 available Immediately	1	\$264.85	\$264.85
TOTAL:						\$303.79

View Details

CLICK "VIEW DETAILS"

- View and Use Buttons on the Bottom to Add to or From Cart.

INVOICE HISTORY

SEE INVOICES FOR ORDERS THAT HAVE SHIPPED & INVOICED

RMA

START A RETURN

SEARCH INVOICES BY SPECIFIC ITEMS!

Home > My Account > Invoice Information

Invoice Information

Invoice #:

Purchase Order #:

Sales Order #:

Web Order #:

Invoice date range:

Limit to Item #

Show All

Get Invoices

Invoice History Tracking Details **2**

THIS IS AN INVOICE
Invoice Number:

Invoice Date: 6/23/2022

Bill To: Ship To:

Invoices

Order	Customer	P.O. #	Ordered By	ShipVia	Terms
				FED GRND	Net 30 Days

Product Description	Item ID	Qty Ord	Qty Ship	Price	Ext
Cell Replacement, Jandy Pro Series TruClear Chlorinator	43-100-1132	1	1	\$342.33	\$342.33
SHIPPING CHARGED TO YOUR 3RD PARTY ACCOUNT	SHIP	1	1	\$0.00	\$0.00

MasterTrackingNo
079825818819657
NoofBoxes
1
ShippingDate
6/23/2022

Non Taxable Subtotal: **\$342.33**
Taxable Subtotal: \$0.00
Tax: \$0.00
Grand Total: \$342.33

1 View Start RMA

Home > My Account > Invoice Information

Invoice Information

Invoice #:

Purchase Order #:

Sales Order #:

Web Order #:

Invoice date range:

Limit to Item #

Show All

Get Invoices

Enter RMA **2**

THIS IS AN INVOICE
Invoice Number:

Invoice Date: 6/23/2022

Show All

Get Invoices

Order	Customer	P.O. #	Ordered By	ShipVia	Terms
				FED GRND	Net 30 Days

Product Description	Item ID	RMA Reason	Qty Rtn	Qty Ship	Price	Ext
Cell Replacement, Jandy Pro Series TruClear Chlorinator	43-100-1132	Select Reason...	0	1	\$342.33	\$342.33
RMA Item Note						\$0.00 \$0.00

Please contact Customer Service at customerservice@horizonspa.com
Properly package and send your return by a shipper that can be tracked. Save your return for lost or damaged returns.

Non Taxable Subtotal: **\$342.33**
Taxable Subtotal: \$0.00
Tax: \$0.00
Grand Total: \$342.33

Name:
Phone:
Copy Email To:
RMA Notes:

Cancel Process RMA Request Print

1 Start RMA

2 Select Reason... 0

CLICK "VIEW"

- INVOICE DETAILS
- TRACKING # LINK

CLICK "START RMA"
TO START THE RETURN PROCESS

REASON & QUANTITY

- Select Reason in Dropdown
- Add Quantity to Return
- Follow All Prompts

UPLOAD / EDIT LOGO

PERSONALIZE THE HORIZON SITE WITH YOUR LOGO

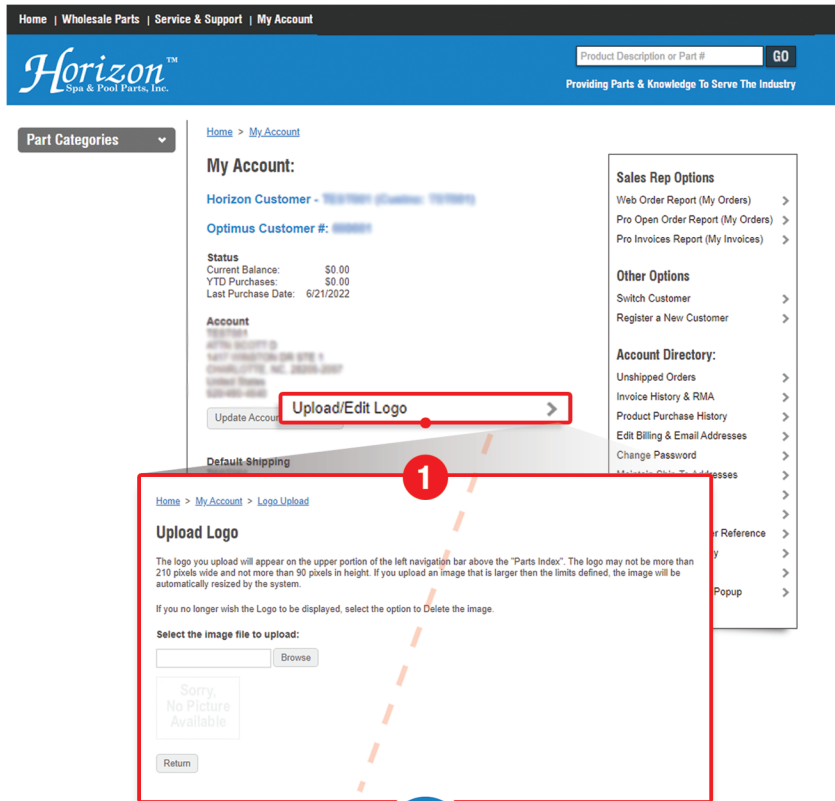

UPLOAD LOGO

Great When Using A Computer, Tablet, or Phone to Show Customers Information About Parts

PRICING DISPLAY & ORDER REFERENCE

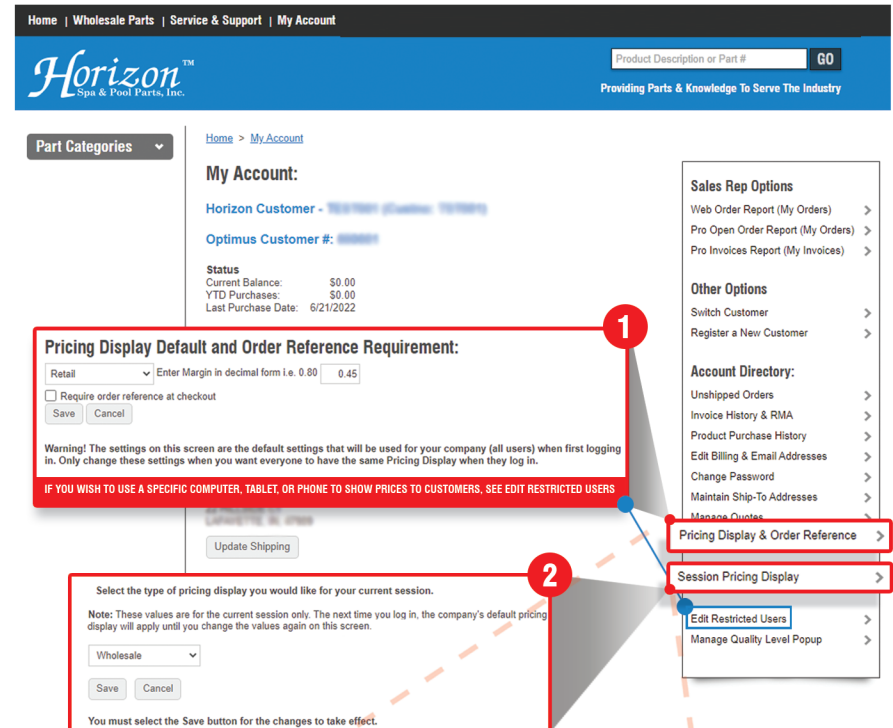

PRICING DISPLAY/ORDER REFERENCE

PERMANENTLY Show No Prices:
Wholesale • Retail
w/ a Specific Margin.

SESSION PRICING DISPLAY

TEMPORARILY Show No Prices:
Wholesale • Retail
with a Specific Margin.

You must log out and restart your browser to clear the session

EDIT RESTRICTED USERS

SET UP RESTRICTED USER TO SHOW CUSTOMER RETAIL PRICING

Home | Wholesale Parts | Service & Support | My Account Log Out | View Cart (7)

HorizonTM
Spa & Pool Parts, Inc. Product Description or Part #

Providing Parts & Knowledge To Serve The Industry

Part Categories ▾

[Home](#) > [My Account](#) > [User Accounts](#) > [Edit User Information](#)

1 Add User

Note: User ID is the login and must be unique.

User Type : Restricted

User Name :

User ID :

Password :

Confirm Password :

Access Control: Retail

Price Display :

User Can Order

Pricing & Catalog Menus Enabled

Dashboard Enabled (User can view purchase history and invoices)

Retail ▾

- Same As Parent
- Wholesale
- Retail
- No Prices Displayed
- User Controlled

User Can Order

Pricing & Catalog Menus Enabled

Dashboard Enabled (User can view purchase history and invoices)

1

Add User

Note: User ID is the login and must be

User Type : Restricted

User Name :

User ID :

Password :

Allows You to Add Individual Users to Your Account and Choose the Level of Access.

2

Access Control:

Price Display:

User Can Order

Pricing & Catalog Menus Enabled

Dashboard Enabled (User can view purchase history and invoices)

Retail ▾

- Same As Parent
- Wholesale
- Retail
- No Prices Displayed
- User Controlled

Pricing Display is an Excellent Way to Show your Customer Their Retail Prices.

3

User Can Order

Pricing & Catalog Menus Enabled

Dashboard Enabled (User can view purchase history and invoices)

Allow or Don't Allow Users to Place Orders, See Download Menus or Account History.